

# In Practice: Zishi Han and Wei Yang

Mar 13–24, 2025

**SculptureCenter**

44-19 Purves Street  
Long Island City, NY 11101  
+1 718 361 1750  
[sculpture-center.org](http://sculpture-center.org)



For In Practice, Zishi Han and Wei Yang present a new phase of their ongoing collaborative research project into historical Chinese homoerotic literature, intertwining multiple narratives that explore queer existences in China and of Chinese diaspora. Emerging from their shared interests in the power dynamics inherent in desire and intimacy, the artists' point of departure is their own translation of the late Ming dynasty anthology of homoerotic stories 弁而釵 (*Biàn ér chāi*) by the pseudonymous "The Moon-Heart Master of the Drunken West Lake," the title of which suggests the action of a man removing his ceremonial headgear and donning a woman's hairpin.

Han and Yang's performance-and-video works loosely interpret and transposes the text's storylines (notably, of an affair between a student and a disguised academician, expressed here in conversations between the student and a close companion) to dwell amidst the blurry boundary between the fictional and the biographical, while drawing on a variety of Chinese historical and contemporary cultural practices, such as poetry, Chinese Opera, literati landscape painting, Danmei literature, C-pop and reality TV shows.

Their exhibition includes a new video alongside sculptures of an overhead net and a fallen gong, creating a visual pun (legible in Mandarin) that plays on the idiomatic impasse of being caught between "two nets," one in the sky and one on the ground.

# Works in the Exhibition

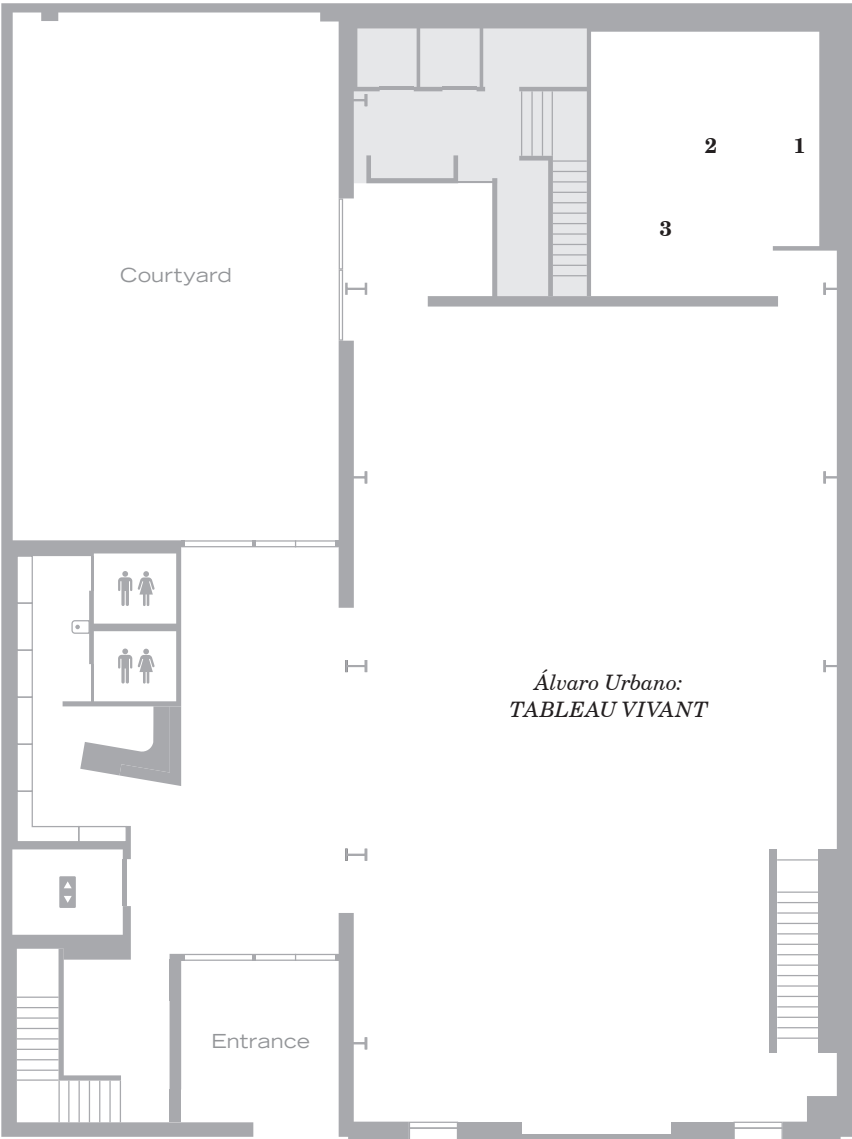

Ground Floor Plan

# Ground Floor

- 1 Zishi Han and Wei Yang  
*Hairpin Beneath 2*  
钗之后 二, 2025  
HD single-channel video, live  
performance, light, color, sound  
29:48 mins

## Video Credits

Directed by Zishi Han and Wei Yang  
Based on the Story and Characters  
Created by The Moon-Heart Master of  
the Drunken West Lake  
Adaptation and Screenplay by Wei  
Yang

Cast (in order of appearance):  
Wei Yang, Chengyu Wu, Antone Liu

Editor: Zishi Han  
Camera: Wei Yang, Zishi Han  
Colorist: John Hussain Flindt, Zishi  
Han

Set Designer: Wei Yang, Zishi Han  
Costume, Hair and Makeup: Xtina  
Vargas, Chengyu Wu, Antone Liu

Dubbing: Wei Yang  
Recording: Zishi Han, Yu Yang  
Sound Design: John Hussain Flindt,  
Zishi Han

Subtitles: Wei Yang, Zishi Han  
Proofreading: Claire Kim

## Performance Credits

Directed by Wei Yang and Zishi Han

Live Performers (in alphabetical  
order): Wei Yang, Yushu Wang,  
Yimiao Liu, Phoebe Chen, Sylvia Ke

Technician: Zishi Han

## Performance Schedule:

Mar 13 at 6pm; Mar 14, 15, 20, 21, and  
22 at 4pm.

- 2 Zishi Han  
*xoxo*, 2025  
Stainless steel beads and cables  
Dimensions variable

- 3 Wei Yang  
*gong gurl*, 2025  
Papier-mâché  
23 × 39 × 39 inches  
(58 × 99 × 99 cm)

All works courtesy the artists

## Special thanks to:

Kyle Dancewicz  
Christopher Aque  
Claire Kim  
Jane DeBevoise  
James Gibbel  
Kamal Nassif  
Juri Simoncini  
Elisa Diaferia  
Giulia Guidi  
Augustine Paredes  
Hangping Yang  
Wanwen Zhang  
Jamie Shi  
Lorenzo García-Andrade  
Junhao Xiang  
Nadh Lingyun Cao  
Kaixin Chen  
Karl Kleim  
Bernhard Schreiner  
Marius Moll  
Siri Black  
Sebastian Stöhrer  
Stefan Wieland  
Hanna-Maria Hammari  
Markéta Adamcová  
Oscar Kargruber  
CFGNY  
Covey Gong

## Performance Schedule

Thur, Mar 13, 6pm  
Fri, Mar 14, 4pm  
Sat, Mar 15, 4pm

Thur, Mar 20, 4pm  
Fri, Mar 21, 4pm  
Sat, Mar 22, 4pm

RSVP Required; Please visit  
[sculpture-center.org](http://sculpture-center.org) to sign up

## Public Programming

Off-Site Talk: Zishi Han and Wei Yang at  
Asia Art Archive in America  
Fri, Feb 21, 6:30pm

Off-Site Talk: Zishi Han and Wei Yang at  
Asia Art Archive in America  
Wed, Mar 19, 6:30pm

## On View Concurrently

*Álvaro Urbano: TABLEAU VIVANT*  
Sep 19, 2024–Mar 24, 2025

*ASMA: Ideal Space for Music*  
Oct 31, 2024–Mar 24, 2025

## In Practice 2024

Covey Gong  
May 11–Jun 19, 2024

Phoebe Collings-James  
Jun 27–Aug 12, 2024

Bastien Gachet  
Sep 19–Oct 21 2024

Tony Chrenka  
Oct 31–Dec 22, 2024

Anita Esfandiari  
Jan 23–Mar 3, 2025

Zishi Han and Wei Yang  
Mar 13–24, 2025

## About In Practice

In Practice 2024 marks the twenty-first anniversary of the program. Each exhibition is the artist's first solo exhibition in a New York City institution, and each artist will present new work commissioned by SculptureCenter.

SculptureCenter is a not-for-profit arts institution that takes the history and legacy of sculpture as a framework from which to consider the diverse activity taking place in the field of contemporary art. SculptureCenter's program encourages artists and audiences to explore the possibilities of sculpture and the multifarious ways in which sculpture is developing and connecting to other forms of expression, including installation, video, performance, architecture, and other media.

Since 2003, SculptureCenter's In Practice open call program has supported the production of new work by 250 artists.

## **Board of Trustees**

Carol Bove  
Chair

Anicka Yi  
President

Eleanor Heyman Propp  
Vice Chair

Helen Warwick  
Vice Chair

Andreas Waldburg-Wolfegg  
Treasurer

Justin Beal  
Secretary

Nairy Baghramian

Candy Barasch

Sanford Biggers

Eleanor Cayre

Richard Chang

Barbara Gundlach

Leslie Hewitt

Sean Lyons

Adam McEwen

Michael Quinn

Samuel Ellis Scheinman

Mary Wang

Houtan Zojaji

## **Staff**

Sohrab Mohebbi  
Director

Kyle Dancewicz  
Deputy Director

Zina Reed  
Director of Development

Jovanna Venegas  
Curator

Cheryl Chan  
Institutional Giving and  
Board Relations Manager

Portia Leggiere  
Development and Special Events  
Assistant

Christopher Aque  
Exhibition and Program Manager

Danny Crump  
Associate Director of Facilities and  
Operations

Olivia Harrison  
Visitor Services Coordinator

Adrian Cebreros-Bueno, Tucker  
Claxton, Drew Hannaoui  
Visitor Engagement Representatives

James Gibbel, Kamal Nassif  
Art Installers

In Practice 2024 is organized by the SculptureCenter curatorial team.

*In Practice: Zishi Han and Wei Yang* is curated by Kyle Dancewicz, Deputy Director and Christopher Aque, Exhibition and Program Manager.

### Asia Art Archive in America

Zishi Han and Wei Yang's time in New York City is organized in partnership with Asia Art Archive in America (AAAinA). In February and March 2025, SculptureCenter and AAAinA will co-present public programming off-site in AAAinA's Brooklyn Heights reading room that expands on the artists' In Practice commission and their ongoing collaboration.

Asia Art Archive in America (AAAinA), founded in 2009, is an independently established and operated U.S. 501(c)3, and the first overseas hub of Asia Art Archive (AAA) in Hong Kong. AAAinA's mission is to collect, preserve, and make accessible information on contemporary art from and of Asia, in order to facilitate public understanding and specialized research to instigate dialogue and critical thinking, and to raise awareness of and support for the activities of AAA globally. To achieve this goal, AAAinA maintains a reading room in Brooklyn, New York which is open to the public free of charge, and comprises over 5,000 monographs, exhibition catalogs, reference books, periodicals, and audio-visual materials about contemporary art related to Asia. AAAinA also organizes a regular program of talks, screenings, workshops, participatory projects, exhibitions, residencies, and panels with artists, curators, critics, and scholars in the field.

### Sponsors

In Practice is made possible by the Elaine Graham Weitzen Commissioning Fund for Emerging Artists, which supports the production of new work by artists selected from SculptureCenter's annual open call. This landmark endowment established in 2024 reflects Elaine Graham Weitzen's (1920–2017) lifelong commitment to emerging artists and her exuberant support of new ideas in art. Weitzen served as a devoted Trustee of SculptureCenter from 1987 to 2017.

Major support for the In Practice program is provided by the Pollock-Krasner Foundation. In Practice is supported in part by an award from the National Endowment for the Arts.

Generous support for In Practice is provided by Sarah Elson.

Support for all of SculptureCenter's work with artists from abroad is provided by the International Council: Anonymous, Stephen Cheng, Micki Meng, Yan Du, Antonio Murzi and Diana Morgan, Audrey Rose Smith and Vicente Muñoz, Thomas Berger, and Füsün Eczacıbaşı - SAHA.

Leadership support for SculptureCenter's exhibitions and programs is provided by Barbara and Andrew Gundlach, Carol Bove, Eva Hesse Charitable Foundation, the Anna-Maria and Stephen Kellen Foundation, and Teiger Foundation. Major support is provided by The Andy Warhol Foundation for the Visual Arts, Eleanor Heyman Propp, Jacques Louis Vidal, Jill and Peter Kraus, Marguerite Steed Hoffman Donor Advised Fund at The Dallas Foundation, Miyoung Lee and Neil Simpkins, and Richard Chang. Generous support is provided by Amy and Sean Lyons, Candy and Michael Barasch, David Andersson & Andrew Fine, David Maclean, Fred Wilson, Jane Hait and Justin Beal, Libby and Adrian Ellis, and the May and Samuel Rudin Foundation, Inc. Additional funding is provided by Julien Sarkozy.