

In Practice: Magdalena Petroni

May 28–Jul 6, 2026

SculptureCenter

44-19 Purves Street
Long Island City, NY 11101
+1 718 361 1750
sculpture-center.org

Magdalena Petroni's practice delves into the subtext of popular visual language, drawing from media, branding, and online subcultures. Layering painting and sculpture, her works are often accumulated within immersive installations designed to envelop the visitor and dissolve boundaries between artworks. Petroni assembles dissimilar objects to explore the dynamism of social, technological, and sexual changes driven by capital, which she calls "a mixture of excitement and anxiety before a monstrous present." For *In Practice*, she examines the glitched edges between the real and the hyperreal through a site-responsive environment that expands on her interest in liminality, perception, disorientation, and drift.

Over several weeks in New York, Petroni (who lives in Chile) built a hybrid movie set and office environment by reworking found materials. In 2020, the pandemic transformed labor and the office. In many cities, artists took over abandoned office spaces and turned them into studios. Petroni reconfigures the corporate workspace as an uncanny studio/stage to debut her first film, which she made from edited crash-test dummy videos. The dummies' mundane, humorous, and surreal dialogue plays off the surroundings, capturing a sentiment of existential dread, entrapment, and acceleration.

Works in the Exhibition

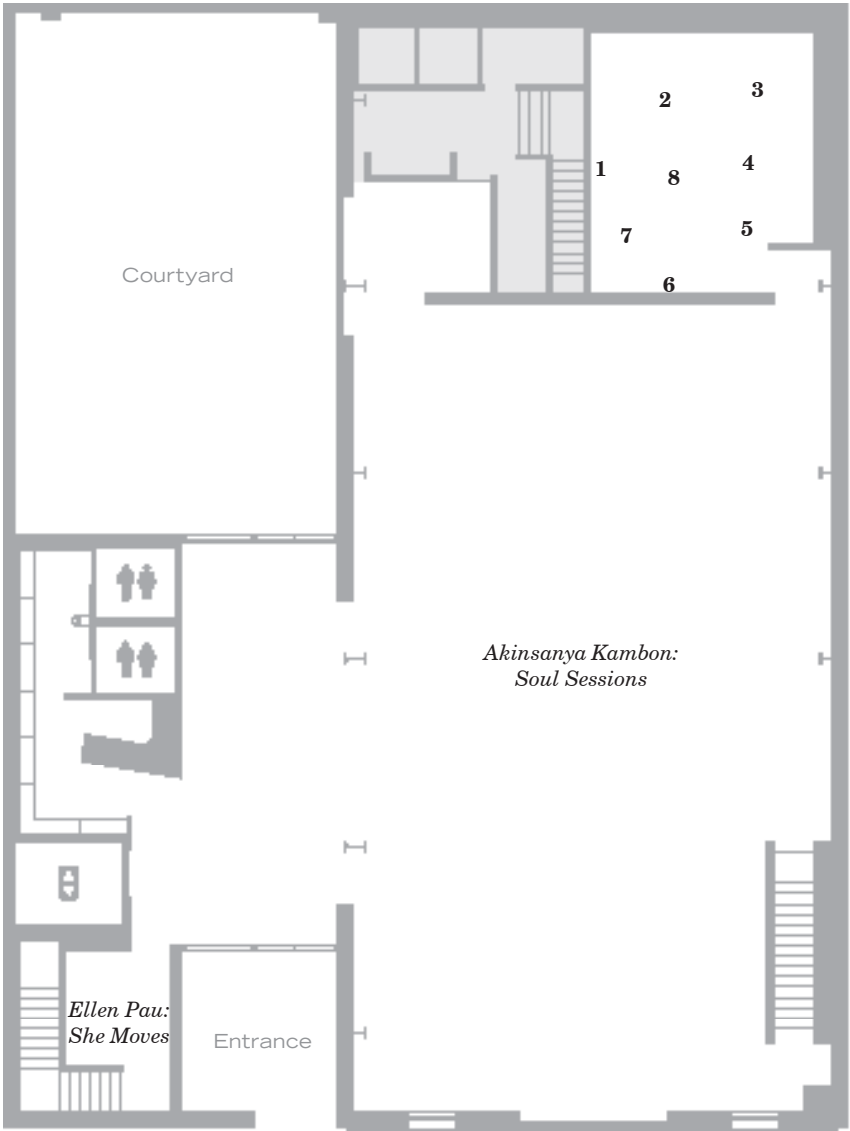

Ground Floor Plan

Gallery B

Say Cheese! (2026) room installation with various components:

- 1 *Say Cheese! 1, 2026*
Single-channel video
4:50 min
- 2 *Say Cheese! 2, 2026*
Car light, office chair, dance pole, sneakers, and tennis balls
118 x 43 x 33 inches
(299.7 × 109 × 84 cm)
- 3 *Say Cheese! 3, 2026*
Car light, sneakers, and dance pole
58 x 29 x 29 inches
(147.3 × 73.5 × 73.5 cm)
- 4 *Say Cheese! 4, 2026*
Car light, office chair, dance pole, and tennis balls
118 x 46 x 27 inches
(299.7 × 117 × 68.5 cm)
- 5 *Say Cheese! 5, 2026*
Chair and dance pole
118 x 28 x 23 inches
(299.7 × 71 × 58.5 cm)
- 6 *Say Cheese! 6, 2026*
Chairs, sneakers, and dance pole fragments
37 x 18 x 23 inches
(94 × 45.7 × 58.5 cm)
- 7 *Say Cheese! 7, 2026*
Office chair and dance pole
118 x 34 x 30 inches
(299.7 × 86.3 × 76 cm)
- 8 *Say Cheese! 8, 2026*
Cardboard
30 x 73 x 50 inches
(76 × 185.5 × 127 cm)

All works courtesy the artist and General Expenses, Mexico City; Tomas Redrado Art, Miami and José Ignacio, Uruguay

Special thanks to Flux Factory

On View Concurrently

Akinsanya Kambon: Soul Sessions
May 28–Aug 16, 2026

Ellen Pau: She Moves
May 28–Aug 16, 2026

In Practice 2025–26

Sam Cottingham and Alejandro Villabona
May 1–Jun 9, 2025

Kevin Hernández Rosa
Jun 19–Jul 28, 2025

Nadim Choufi
Oct 2–Nov 3, 2025

Coco Klockner
Oct 18–Dec 22, 2025

Ana Gzirishvili
Jan 29–Apr 27, 2026

Magdalena Petroni
May 27–Jul 6, 2026

Michaela Bathrick
Jul 16–Aug 16, 2026

About In Practice

Each year, In Practice invites artists who have not yet had an institutional solo exhibition in New York City to submit proposals for solo exhibitions in designated gallery spaces at SculptureCenter.

SculptureCenter is a not-for-profit arts institution that takes the history and legacy of sculpture as a framework from which to consider the diverse activity taking place in the field of contemporary art. SculptureCenter's program encourages artists and audiences to explore the possibilities of sculpture and the multifarious ways in which sculpture is developing and connecting to other forms of expression, including installation, video, performance, architecture, and other media.

Since 2003, SculptureCenter's In Practice open call program has supported the production of new work by 270 artists.

Board of Trustees

Helen Warwick
Chair

Anicka Yi
President

Eleanor Heyman Propp
Vice Chair

Andreas Waldburg-Wolfegg
Treasurer

Justin Beal
Secretary

Dalal Ani Arnold
Nairy Baghramian
Candy Barasch
Carol Bove
Sanford Biggers
Richard Chang
Leslie Hewitt
Tina Kim
Sean Lyons
Adam McEwen
Michael Quinn
Samuel Ellis Scheinman
Seth Stolbun
Barbara von Portatius
Mary Wang
Houtan Zojaji

Staff

Sohrab Mohebbi
Director

Kyle Dancewicz
Deputy Director

Jovanna Venegas
Curator

Sharon X. Liu
Asymmetry Curatorial Fellow

Cheryl Chan
Institutional Giving and
Board Relations Manager

Portia Leggiere
Development and Special Events
Assistant

Christopher Aque
Exhibition and Program Manager

Kamal Nassif
Head Installer

Theadora Walsh
Writer and Content Editor

Danny Crump
Associate Director of Facilities and
Operations

Olivia Harrison
Visitor Services Coordinator

Drew Hannaoui, Jo Kim, Horacio
Lopez
Visitor Engagement Representatives

Mika Agari, Kiko Bordeos, Patrick
Costello, James Gibbel, Val Karuskev-
ich, Katie Logan, Johnny Nguyen,
Camila Ortiz, Rogerio Fernandes
Tavora
Art Installers

In Practice 2025–26 is organized by the SculptureCenter curatorial team.

In Practice: Magdalena Petroni is curated by Jovanna Venegas, Curator, and Kyle Dancewicz, Deputy Director.

Sponsors

In Practice is made possible by the Elaine Graham Weitzen Commissioning Fund for Emerging Artists, which supports the production of new work by artists selected from SculptureCenter’s annual open call.

Major support for the In Practice program is provided by the Pollock-Krasner Foundation.

Generous support for In Practice is provided by Sarah Elson and Fundación Proa.

Support for all of SculptureCenter’s work with artists from abroad is provided by the International Council: Anonymous, Stephen Cheng, Yan Du, Thomas Berger, Antonio Murzi and Diana Morgan, Füsün Eczacıbaşı - SAHA, Yuan Han Li, and Audrey Rose Smith and Vicente Muñoz.